

SHREWSBURY TOWN

COUNCIL

1 NOV 2017

RECEIVED

Shropshire Council
Shirehall
Abbey Foregate
Shrewsbury
SY2 6NDClerk to Shrewsbury Town Council
Riggs Hall
The Library
Castle Gates
Shrewsbury
SY1 2ASDate: 30th October 2017
My ref: LP/DEV-3089
Your ref:

Dear Sirs

**Stopping Up Order
Section 116 Highways Act 1980
Land at Somerby Drive, Shrewsbury**

Further to previous correspondence please now find attached a copy of the Notice and plan showing Shropshire Council's application to stop up highway land adjacent at Somerby Drive, Shrewsbury under the provisions of Section 116 of the Highways Act 1980.

Your authority has already indicated that it does not have any objection to this application

Yours sincerely

Louise Prince
Solicitor
Legal Services
louise.prince@shropshire.gov.uk
01743 252798

**SHROPSHIRE COUNCIL
HIGHWAYS ACT 1980 – SECTION 116
LAND AT SOMERBY DRIVE, SHREWSBURY**

NOTICE IS HEREBY GIVEN that the Shropshire Council of the Shirehall, Abbey Foregate, Shrewsbury, Shropshire, SY2 6ND intends to apply to Shropshire Magistrates sitting at Telford Magistrates Court, Telford Square, Malinsgate, Telford, Shropshire, TF3 4HX on Thursday 30th November 2017 at 10:00 a.m. for an Order under Section 116 Highways Act 1980 authorising the stopping up of a part of the highway at Somerby Drive, Shrewsbury, Shropshire in the following manner:

By stopping up an area of land being approximately 18.48 metres at its maximum length and 11.95 metres at its maximum width as shown coloured pink on the plan and being made up of tarmac on the grounds that that part of the highway is unnecessary for public use.

A copy of this Notice and plan may be inspected free of charge during normal office hours at the Shirehall, Abbey Foregate, Shrewsbury SY2 6ND.

Any person wishing to object to the proposal or make representations about it may appear at the hearing of the date and time shown above. Any such person intending to attend the hearing is requested to contact Legal Services at the Shirehall quoting reference LP/DEV-3089.

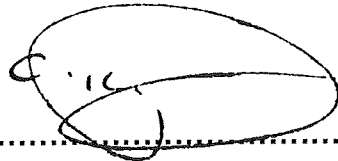

SIGNED

**CLAIRE PORTER – HEAD OF LEGAL & DEMOCRATIC SERVICES
THE SHIREHALL, ABBEY FOREGATE, SHREWSBURY, SY2 6ND**

DATE 19th October 2017

(Data Protection: please note that any representations received including names and addresses may be reproduced stored copied and/or published online in accordance with the processing of the proposed application and the Court hearing. Information will not be used for additional purposes without consent. Representations without a name and address will be treated as anonymous, which may effect the weight they would be given in any Court hearing. Any details published online will exclude individuals e-mail addresses and telephone numbers)

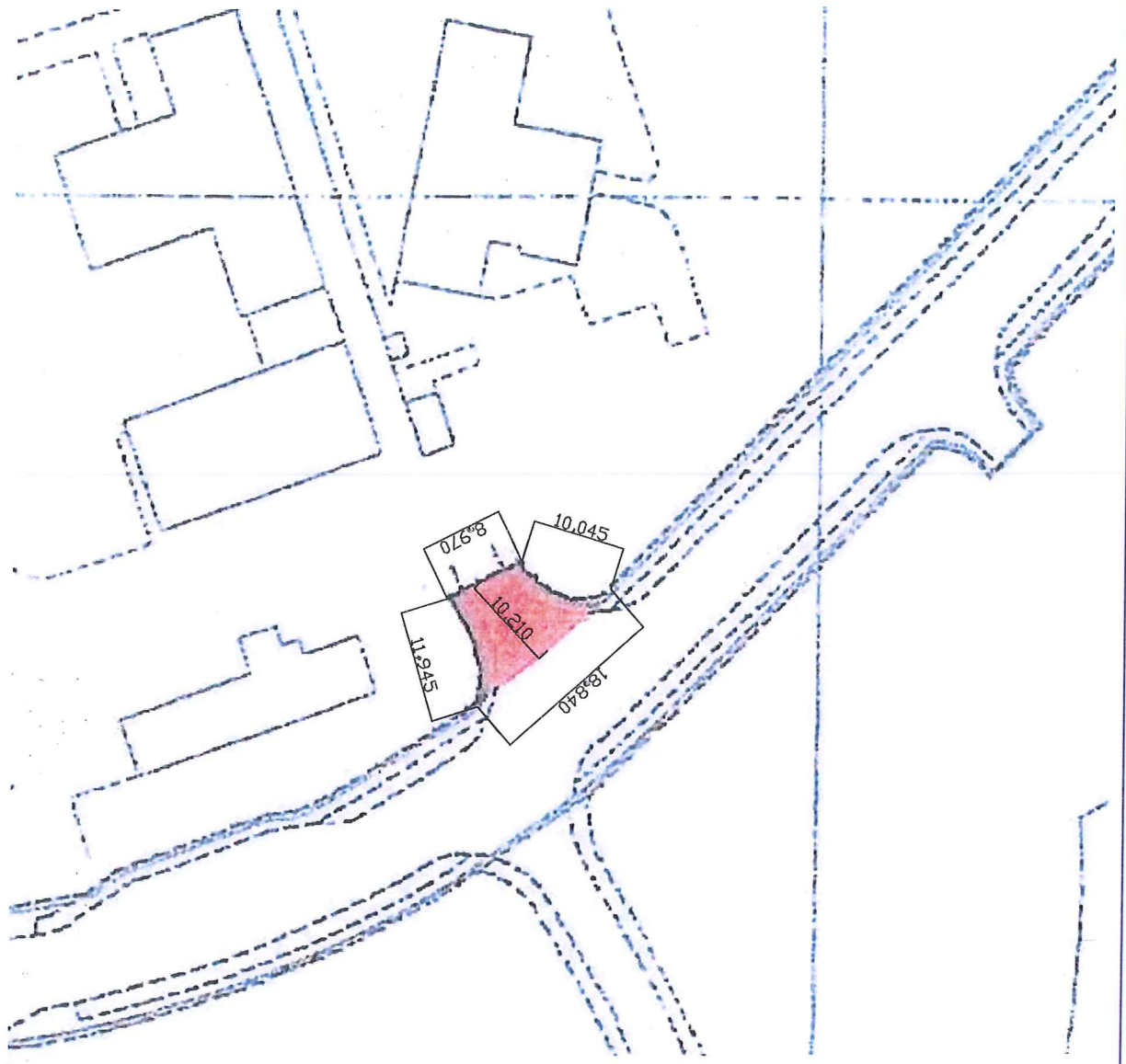

H.M. LAND REGISTRY		TITLE NUMBER
ORDINANCE SURVEY PLAN REFERENCE	SJ4612 SJ4613	SL91897
COUNTY SHROPSHIRE	USHER, SANDS, AND AITCHISON	DATE 1/1/80
		© Crown Copyright



SHROPSHIRE HOMES LTD

THE OLD WORKHOUSE - CROSS HOUSES - SHROPSHIRE - ST3 6JH
 TELEPHONE: (01743) 761788 . FACSIMILE (01743) 761773

JOB	Shelton Hospital, Shrewsbury	TITLE	Land Registry - Turning Head
DWG No.	SH-P-TH	DATE	April 2017
DRAWN	S. Cain	CHECKED	
		SCALE	1/500 @ A3
		REVISION	